

THIS DRAWING AND ANY REPRODUCTIONS ARE THE PROPERTY OF THE ARCHITECTS AND MAY NOT BE REPRODUCED, PUBLISHED, MODIFIED, OR USED IN ANY WAY WITHOUT EXPRESS WRITTEN NOTICE FROM THE ARCHITECT. DRAWINGS AND ANY REPRODUCTIONS OF THEM SHALL NOT BE SCALED OFF FOR ANY PURPOSE. ANY DISCREPANCIES IN THE DRAWINGS SHALL BE REFERRED IMMEDIATELY TO THE ARCHITECT FOR CLARIFICATION PRIOR TO CONTINUING WITH THE WORK. CONFORMANCE WITH THE WORK SHALL BE CONSIDERED ACCEPTANCE OF THE INTENT OF THE DRAWINGS. THE CONTRACTOR IS RESPONSIBLE FOR THE COORDINATION, SCHEDULING, AND CONFIRMATION OF THE WORK OF INVOLVED TRADES. COPYRIGHT 2009, BDG ARCHITECTS, INC. ALL RIGHTS RESERVED.

Imagine International Academy
2144 S. Cobb Drive
Smyrna, GA. 30080
Oakhurst Realty Partners
217 N. McDonough St., Suite 200 Decatur, GA. 30030

GENERAL NOTES

- A. COORDINATE ALL WORK WITH ALL TRADES AND THE PROJECT SCHEDULE.
- B. ALL REMOVED LAMPS AND BALLASTS SHALL BE LEGALLY DISPOSED OF IN ACCORDANCE WITH GEORGIA STATE LAW.
- C. FIELD LOCATE ALL UNDERGROUND UTILITIES AND OBSTRUCTIONS. ANY UNDERGROUND UTILITIES SHOWN ARE DIAGRAMMATIC ONLY AND ARE SHOWN AS APPROXIMATE FOR REFERENCE ONLY.

DEMOLITION NOTES

- ① EXISTING GEORGIA POWER TRANSFORMER. COORDINATE WITH POWER COMPANY FOR POWER DISCONNECTION.
- ② TYPICAL, DISCONNECT AND REMOVE ALL EXISTING LIGHT FIXTURES. REMOVE ALL ASSOCIATED SWITCHES, WIRING AND CONDUITS.
- ③ TYPICAL, DISCONNECT AND REMOVE ALL EXISTING ELECTRICAL PANELS, SYSTEMS CABINETS, DATA EQUIPMENT AND ALL RELATED WIRING AND CONDUIT.
- ④ DISCONNECT AND REMOVE MAIN SWITCHBOARD ELECTRICAL PANELS AND TRANSFORMERS. REMOVE ALL ASSOCIATED WIRING AND CONDUIT. FOR CONDUITS UNDERGROUND, REMOVE WIRING AND CUT CONDUIT AT FLOOR LEVEL FILL WITH CONCRETE TO MATCH FLOOR FINISHING.
- ⑤ DISCONNECT AND REMOVE ALL ROOF ELECTRICAL RELATED EQUIPMENT SUCH AS: EQUIPMENT DISCONNECTS, LIGHTS, WIRING AND CONDUITS.
- ⑥ DISCONNECT AND ABANDON IN PLACE ALL 2ND FLOOR MECHANICAL ROOM ELECTRICAL EQUIPMENT. EQUIPMENT TO BE REMOVED DURING PHASE II.

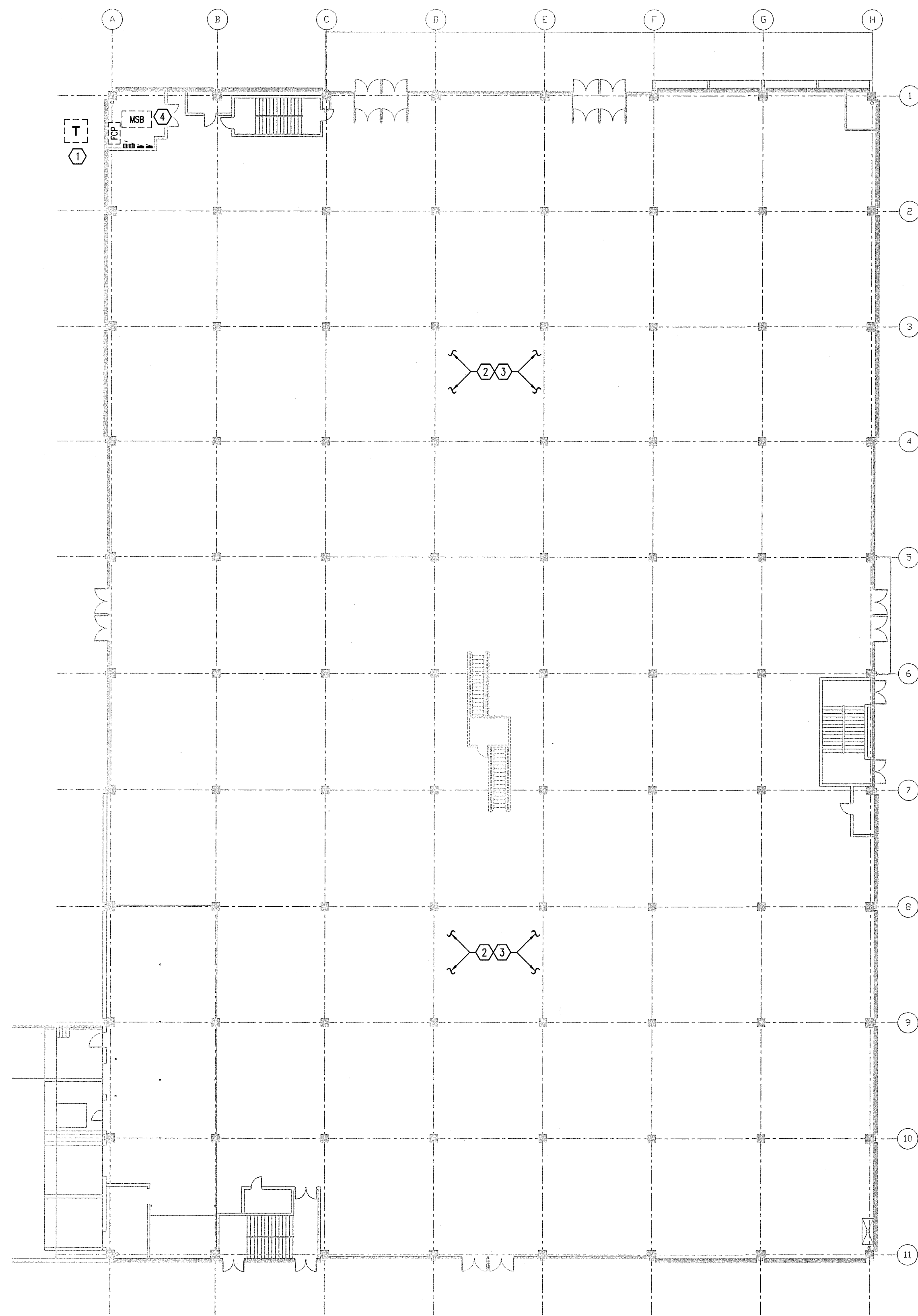

FIRST FLOOR - ELECTRICAL DEMOLITION PLAN

SCALE: 1"= 20'-0"

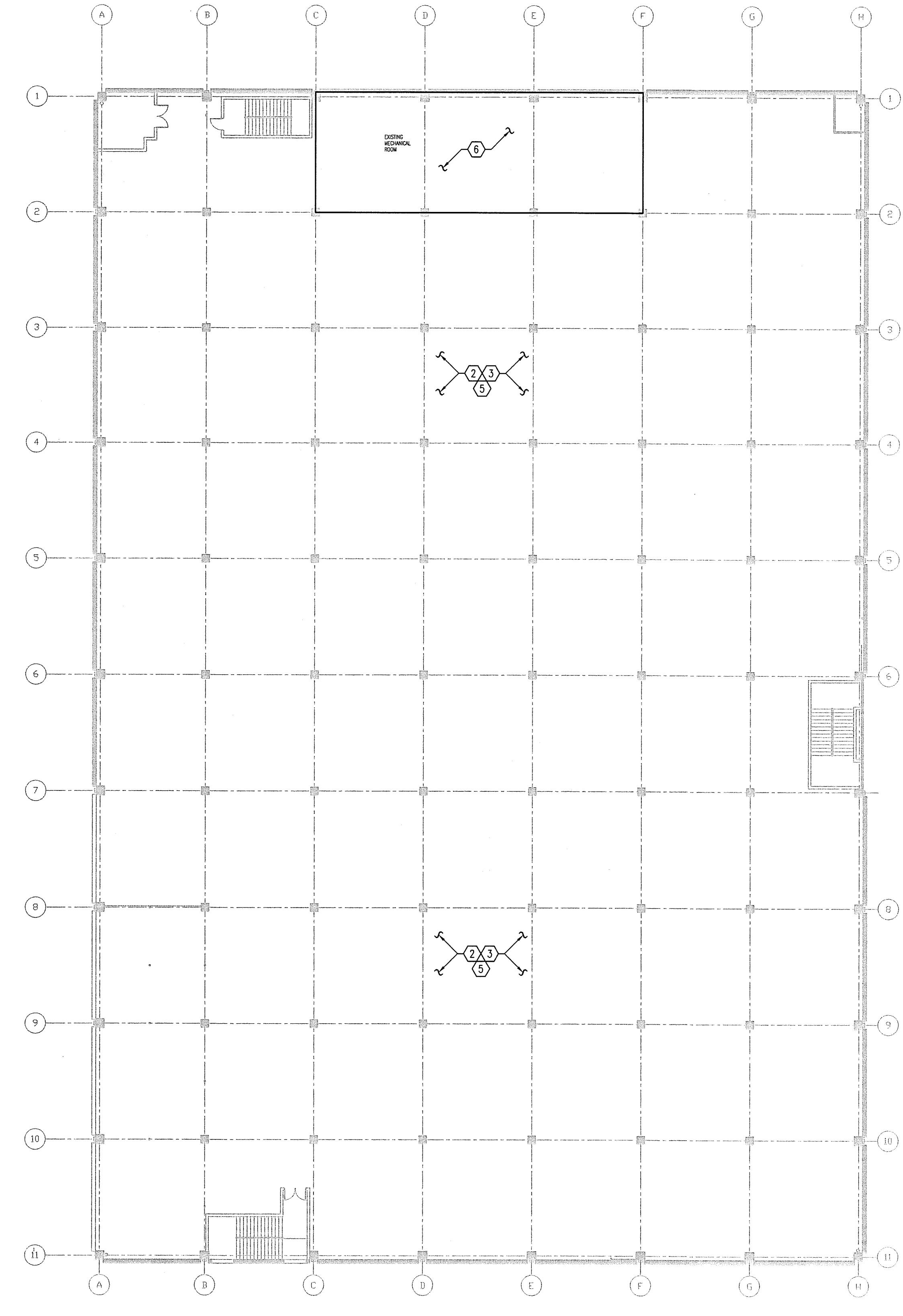

SECOND FLOOR - ELECTRICAL DEMOLITION PLAN

SCALE: 1"= 20'-0"

REV.	DATE & COMMENTS	BY
①	ADDENDUM #1	4-17-2009
△		
△		
△		
△		
△		

JOB NUMBER: 08033
DATE: MARCH 20, 2009
DRAWN BY: FM
SCALE: AS NOTED
DRAWING: FIRST FLOOR AND SECOND FLOOR

ELECTRICAL DEMOLITION PLANS

SHEET NUMBER
E-1.1

KPI
PROFESSIONAL ENGINEERS
3203 QUEEN PALM DRIVE
TAMPA, FLORIDA 33619
PHONE (813) 241-6488
FAX (813) 241-6486
Board of Professional Engineers - License # 27356

RICHARD L. HOCUTT P.E.
GA. LIC. No. 033321
Signature _____ Date _____